

Safety information and rules of behaviour

for visitors to Vetter GmbH Kabelverlegetechnik

A warm welcome

We are very pleased to welcome you to our company premises. These rules of behaviour are binding for all persons entering or driving on the premises. Your own well-being and the safety of all are paramount.

We ask you to read the rules of behaviour carefully and act accordingly. If you have any questions, please do not hesitate to contact our staff immediately.

Thank you for your understanding and co-operation.

Vetter GmbH Kabelverlegetechnik

Industriestraße 28
D-79807 Lottstetten

Tel. +49 7745 9293-0
info@vetter-kabel.de | www.vetter-kabel.de

Business hours

Mon. to Fri. 07.30 – 12.00 and 12.30 – 16.30

Goods receipt and goods issue

Mon. to Fri. 07.30 – 12.00 and 12.30 – 16.00

Visitor parking and delivery / collection by lorry

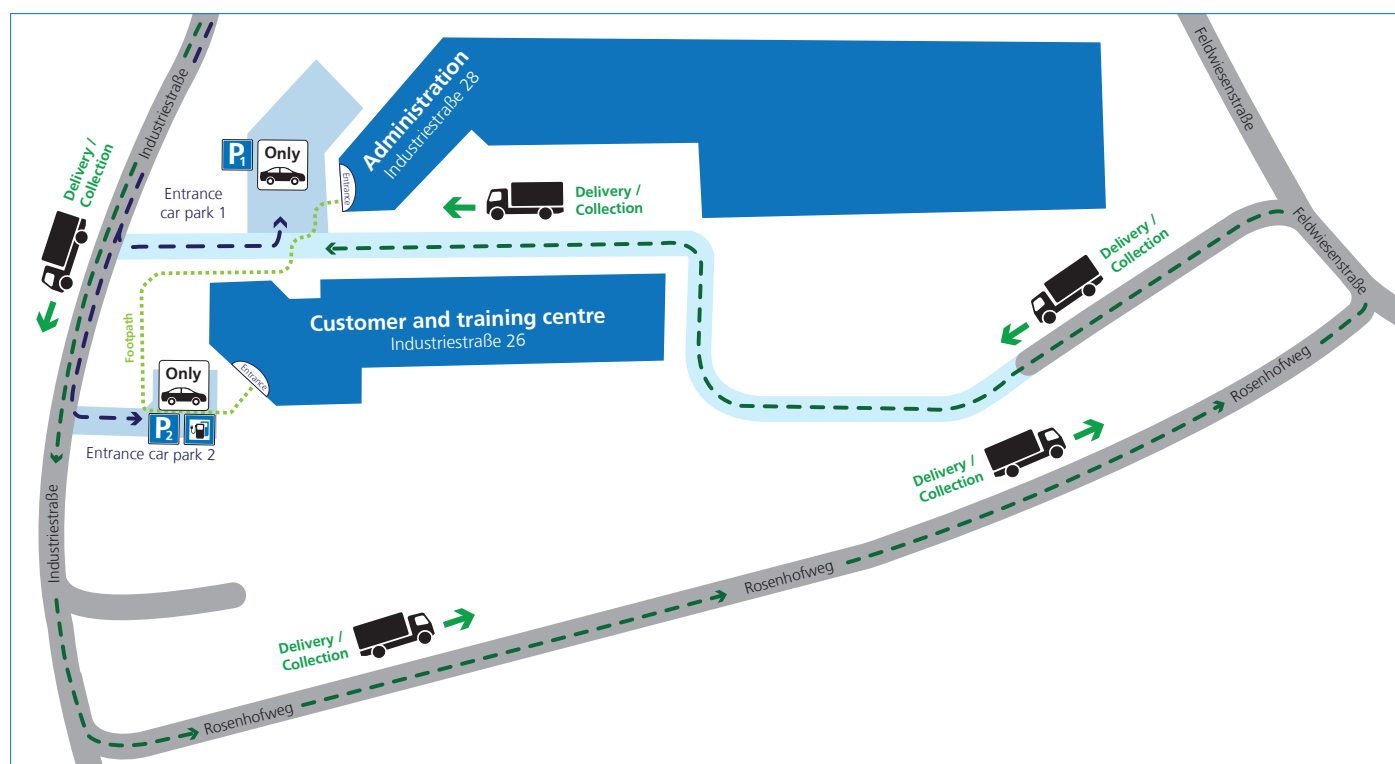

Safety information and rules of behaviour



for visitors to Vetter GmbH Kabelverlegetechnik

Status 1/2026

For a pleasant and safe stay in our company, we ask you to observe the following rules of behaviour:

Identification

Please register at the administration reception desk on arrival to document your attendance and also your later departure. Seminar visitors should register directly at reception in our customer and training centre 10 minutes before the start of the seminar. Please wear the visitor badges issued by us clearly visible so that everyone can recognise your authorised presence on our premises or in our company buildings. When you leave the premises, please return it to the reception desk or to the person accompanying you.

Third parties may only enter our company premises if accompanied and supervised by one of our employees. Visitors are not permitted to move around the company premises alone.

General safety information



Protect yourself and our employees by observing our safety regulations. Safety footwear is compulsory in the labelled areas of the company. The safety footwear requirement also applies during practical demonstrations at seminars, equipment briefings or training sessions, cable tests and all other equipment demonstrations in the buildings or on our outdoor facilities. Always bring your own safety shoes to all

these events. We can only provide with steel-toed overshoes in an emergency. Please also observe and follow the trainer's instructions regarding the use of safety goggles and hearing protection.

It is strictly forbidden to bring and consume alcohol and intoxicants on the premises. Follow the instructions of the person accompanying you.

Specific operating areas



In specific operating areas, access for unauthorised persons is not permitted. Please only go where you are directed by the person accompanying you.

Material, transport and traffic



There is a lot of lorry and forklift traffic on the company premises and in the halls of the company buildings. Please be attentive and follow the warning signs and the instructions of the person accompanying you.

Health risks



Wearers of pacemakers or implants must avoid the areas labelled accordingly.

First aid – ambulance service



There are numerous trained first aiders in our company. An overview is displayed next to the first aid boxes in the company buildings.

Accident and fire



Emergency call 112

Our fire safety officer and our fire safety assistants can be found on the overviews next to the first aid kits.



Leave the areas on the designated escape and rescue routes.



Go directly to the assembly point and wait for further instructions or orders.

Company premises

The rules of the German road traffic regulations apply throughout the company premises with the following special features:



A speed limit of 10 km/h applies to motor vehicles. Forklift trucks have priority.



Video surveillance on the entire company premises.



Vehicles may only be parked in the designated car parks.



Disabled parking spaces are marked accordingly.



Four parking spaces with electric charging stations for electric and plug-in hybrid vehicles are available in front of the customer and training centre. These can be charged free of charge after our activation.

Smoking ban



To minimise the risk of fire, smoking is generally prohibited on the company premises and in the company buildings, with the exception of designated smoking areas.

Cleanliness



Please dispose of waste in the bins provided for this purpose.